

A•smoke²⁰ Oil Smoke Collector

The Absolent type A•smoke²⁰ oil smoke collector features one of the most effective systems in the world for cleaning oil mist and oil smoke. The filter unit is being placed adjacent to one or several machines. The A•smoke²⁰ filter unit is designed for handling tough applications with air flows up to 1180 cfm.

The highest possible collecting efficiency.

The filtered air becomes so clean that it usually can be returned to the premises. This means less loss of energy and a more balanced ventilation.

Designed for oil smoke.

Oil smoke particles are very small, smaller than 1.0 micron. Other types of collectors, as for example centrifugal collectors, have difficulties with small particles. The Absolent filter unit is designed just for this purpose.

Extremely low maintenance.

Absolent units can usually run for at least one year without requiring a filter change. This results in a low total cost of ownership.

A very reliable filter unit.

The fan, as the only moving component, is placed at the clean-side to minimize wear & tear.

Extremely low noise level for agreeable working conditions.

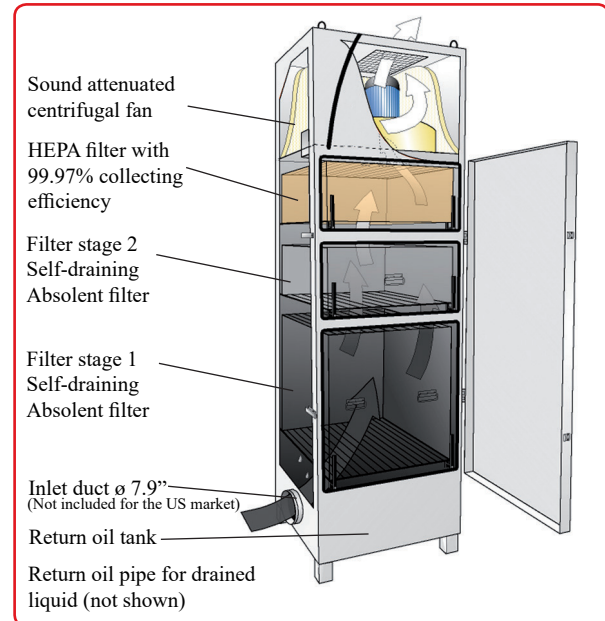

Operation

The filtering process occurs in three stages. The process air passes first through a self-draining Absolent filter cassette. Here, the bigger part of the oil mist and smoke is arrested. When the filter is saturated, the liquid drops into the return oil tank. The air continues through another Absolent cassette, where the rest of the bigger particles is arrested. The third stage consists of a HEPA filter, which has a guaranteed and consistent collecting efficiency of 99.97% arresting 0.3 micron dia. particles. Every stage has a pressure gauge that indicates when a filter change is necessary. Thanks to the continuous draining of the cassettes, the unit can be operated without interruptions. The return oil is collected at the bottom of the filter for recycling.

Range of Application

The Absolent A•smoke²⁰ is well suited for use in applications such as:

- Rotary transfer machines (Hydromats)
- Grinding (high-speed)
- Minimal lubrication
- Hardening
- Milling and CNC-turning involving neat oil lubrication
- Gear cutting

Design

The A•smoke²⁰ contains an electronic manometer, which shows the unit's time of operation as well as the state of the cassettes. The unit has a spacious door for safe and easy service and is supplied with a baked powder painted finish.

Unique filter cassettes



Absolent is one of few companies in this line of business that has specialized in the filtration of air containing wet particles. This has given us the opportunity to develop a filter cassette that offers a long useful life with consistently high collecting efficiency.

Sound level, dB(A)¹⁾

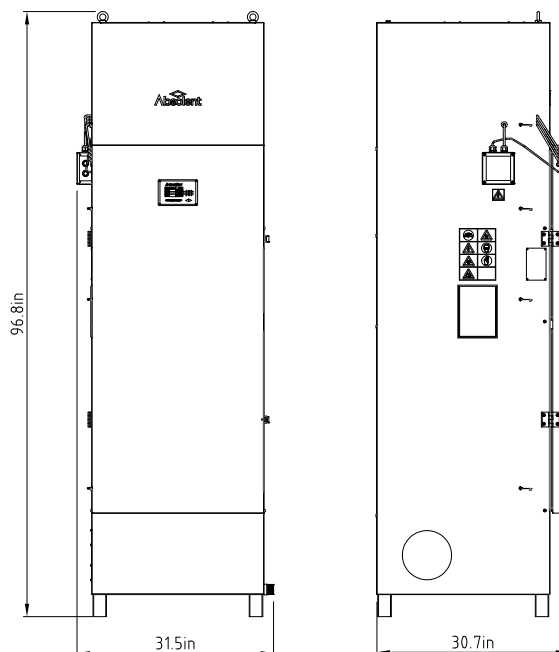
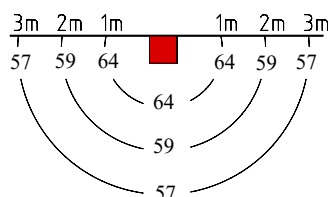

Technical Data		A•smoke ²⁰
Max permissible air volume	[cfm]	1180
Sound level, 1m in front of filter unit ¹⁾	[dB(A)]	64
Weight (dry filters)	[lbs]	617
Available dim. ext. pressure drop	[in WC]	1.73
Filter area, filter 1 (Absolent filter)	[ft ²]	123
Filter area filter 2 (Absolentfilter)	[ft ²]	146
Filter area, filter 3 (HEPA filter)	[ft ²]	219
Fan Data		
Motor output	[hp]	3.5
Power supply	[V]	440-480
Rated current (3-Phase, 400V)	[A]	4.6

¹⁾ Sound absorption in premises=2153ft², Hemispherical sound propagation. For sound calculation concerning a specific room, contact us at Absolent or any of our dealers.

Standard Equipment

- RAL 7035 fine structure
Other colours on request!
- Electronic manometer for reading the pressure drop across the filter cassettes.

Accessories

- Motor starter for fan. Either a manual or protective motor contactor (for automatic or external starting)
- Outlet hood
- Carbon filter
- Connection piece for various types of steel or plastic tubular ducts.

- Extension legs, (standard height 15.75 in).
- Water trap for various connections of the return oil pipe.
- Pump unit for pumping the return oil from the filter.
- Sound insulation (-3 dB)
- Extra outlet silencers (-2 dB).
- Pressure monitor, for external alarm or alarm indications with LED
- Special colours
- Filter sledge for simple handling of used filter cassettes

Electronic manometer

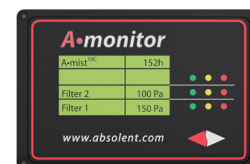

- Pressure drop and operation hour meters
- Optical indication of filter alarm (LED).
- Digital output signal for remote supervision.



Sweden • Germany • China • France • USA

8601 Six Forks Road | Suite 400 | Raleigh, NC 276150 | USA

Phone: +1 (919) 882 2075

E-mail: info@absolent.com

Dealer: