

A•mist^{10C} Compact Oil Mist Filters

Absolent's new A•mist^{10C} is extremely effective for cleaning oil mist. Choose between three different exhaust levels depending on your local particle emission regulations or company policy. Take total control of your working environment with A•mist^{10C}, the first oil mist filter with an electronic LCD monitor!

Tailor-make your installation

The A•mist^{10C} filter unit is available with either a single or two filtration stages. Simply choose the filtration efficiency you want to achieve.

Typical filtration efficiency chart

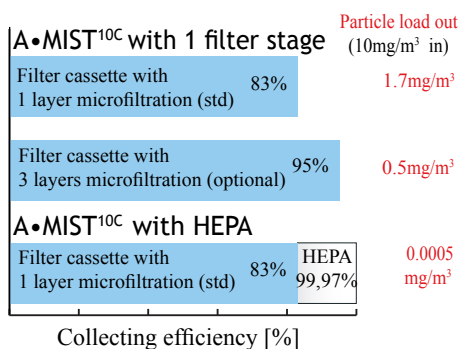

Designed for flexibility

The A•mist^{10C} has a compact design with multiple attachment points which offer great mounting flexibility: on the machine, hung from the ceiling, put on a stand. Service is easy - just open the front cover like a bonnet. If operation conditions change, a HEPA filter can be added later on.

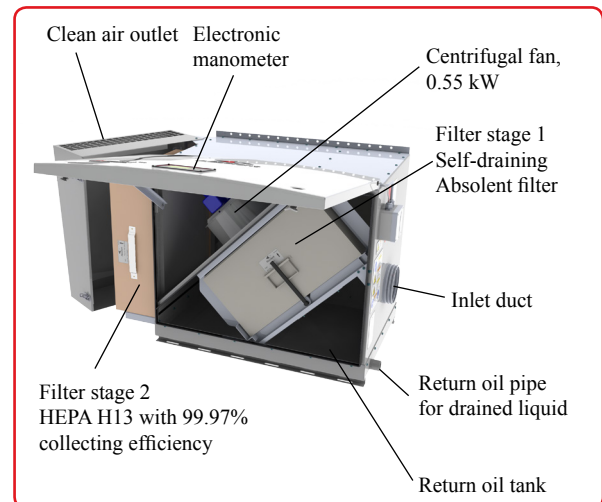

Operation

The filtering process occurs in either one or two stages. The first stage consists of the self-draining Absolent filter, in which up to 95% of the oil mist is collected. If you choose two-stage filtration, the unit includes a H 13 HEPA filter rated at 99.97% @ mpps (≈ 0.14 microns). The status of the filter cassettes are monitored by an electronic manometer, which monitors and indicates when a filter needs to be changed or washed. The electronic manometer can also provide an external alarm signal to the machine operator or to a central service desk.

Thanks to the continuous draining of the filter cassettes, the unit can be operated without interruptions. The return oil is collected at the bottom of the filter for recycling or waste. Of course you have a two year machine warranty for the A•mist^{10C}. This excludes filter cassettes as they are consumables.

Cost effective

Absolent filter units usually run for at least one year without requiring filter change. In the majority of applications, Absolent filter cassettes are washable*). The result is an extremely cost efficient oil mist filtration, creating a clean air stream that can be returned into the plant. Subsequently, heating or cooling energy is preserved and the general HVAC balance in the plant is easier maintained.

*This does not apply for HEPA filters.

Range of application

The Absolent A•mist^{10C} compact filter is well suited for applications such as:

- Grinding (cutting fluid emulsion)
- Turning (cutting fluid emulsion)
- Milling (cutting fluid emulsion)
- Electrical discharge machining
- Machining using neat oil and moderate loads

A•mist^{10C}

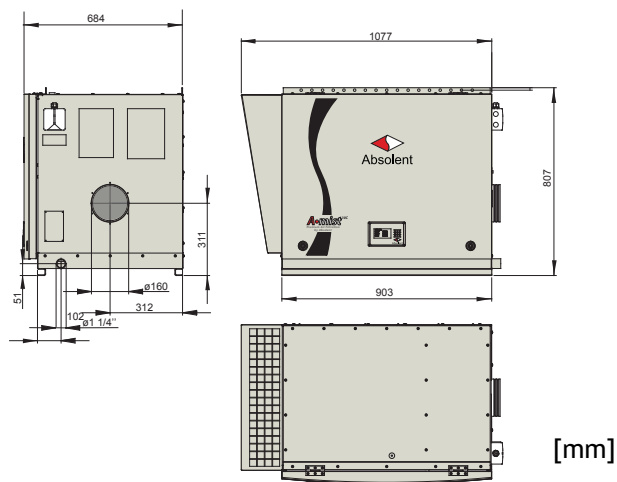

A•mist^{10C} (with HEPA)

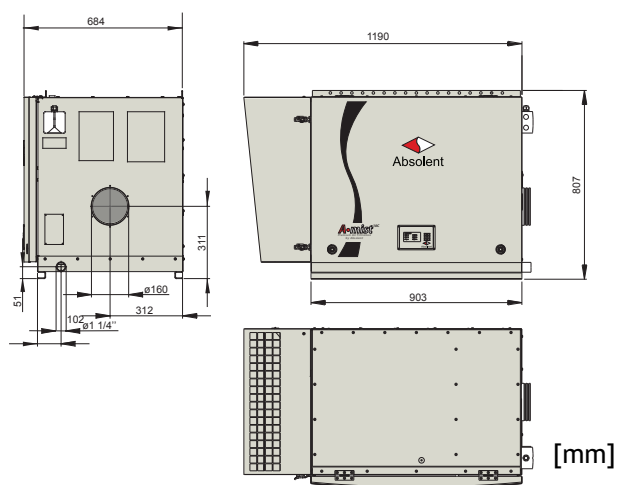

Technical data		A•mist ^{10C}	A•mist ^{10C} HEPA
Max permissible air volume	[m ³ /h]	1000	1000
Sound level, 1m in front of filter unit ¹⁾	[dB(A)]	65	60
Weight (dry filters)	[kg]	110	130
Filter area, filter 1 (Absolent filter) ²⁾	[m ²]	10.4-12.8	12.8
Filter area, filter 2 (HEPA-filter)	[m ²]	-	20.4
Available dim. ext. pressure drop	[Pa]	200	100
Fan data			
Motor output	[kW]	0.55	0.55
Power supply	[V]	380-420	380-420
Rated current (3-Phase, 400V)	[A]	1.2	1.2
Power supply	[V]	200-240	200-240
Rated current (1-Phase, 230V)	[A]	2.09	2.09
Speed	[rpm]	2800	2800

¹⁾ Sound absorption in premises=200m², hemispherical sound propagation. For sound calculation concerning a specific room, contact us at Absolent or any of our dealers.

²⁾ Different filter cassettes are available on request.

Ongoing product development may subject our specifications to alteration without notice.

Electronic manometer

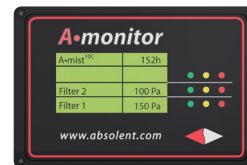

- Pressure drop and operation hour meters.
- Optical indication of filter alarm (LED).
- Digital output signal for remote supervision.

Unique filter cassettes

Absolent is one of few companies in this line of business that has specialized in the filtration of air containing wet particles. This has given us the opportunity to develop a filter cassette that offers a long useful life with consistently high separation efficiency.

SOUND LEVEL without (with) HEPA, [dB(A)]¹⁾

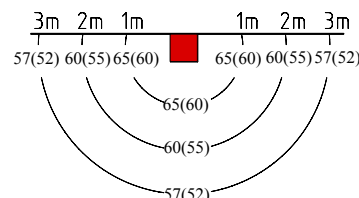

Standard equipment

- RAL 7035 Fine structure SK3. Other colours available on request!
- Electronic manometer for reading the pressure drop across the filter cassettes.
- IE2 Motor with lower energy consumption
- Outlet hood for upward airstream
- Multiple attachment points for lifting, mounting and hanging on the ceiling.

Accessories

- Frequency converter
- Motor starter for fan. Either manual or protective motor contactor (for automatic or external starting).
- HEPA module for retrofitting of unit supplied without HEPA.
- Outlet duct connection
- Water trap for various connections of the return oil pipe.
- Spray system
- Equipment for floor positioning, wall mounting or hanging on the ceiling.

Absolent AB
Kartåsgatan 1
SE-531 40 Lidköping
Sweden
Tel: +46 (0)510-484000
Fax: +46 (0)510-484029
E-mail: info@absolent.se
Sweden • USA • China



Dealer: